



www.billbeall.com

Retail Space - **FOR LEASE**

605 W. 12th Street

Lamar, MO 64759



HIGHLIGHTS

- REMODELED CENTER
- 11,125 SF Retail Space Available - **Could be Divided**
- Lot Size: 3.56 Acres
- Existing Tenants: Family Dollar, Wilkinson Pharmacy, H&R Block
Jessica Edwards Photography & Vapor Maven
- NNN: +/- \$0.85 / SF = \$788.00 / Month
- Rent: \$4.00 / SF = \$3,709.00 / Month
- Suite F: 11,125 SF * Estimated Monthly Payment = \$4,497.00



FOR ADDITIONAL INFORMATION PLEASE

Bill Beall Co., Inc.

2921 S. National Ave., Springfield, MO 65804

(417) 887-5535 email: beall@billbeall.com

605 W. 12th Street

Lamar, MO 64759

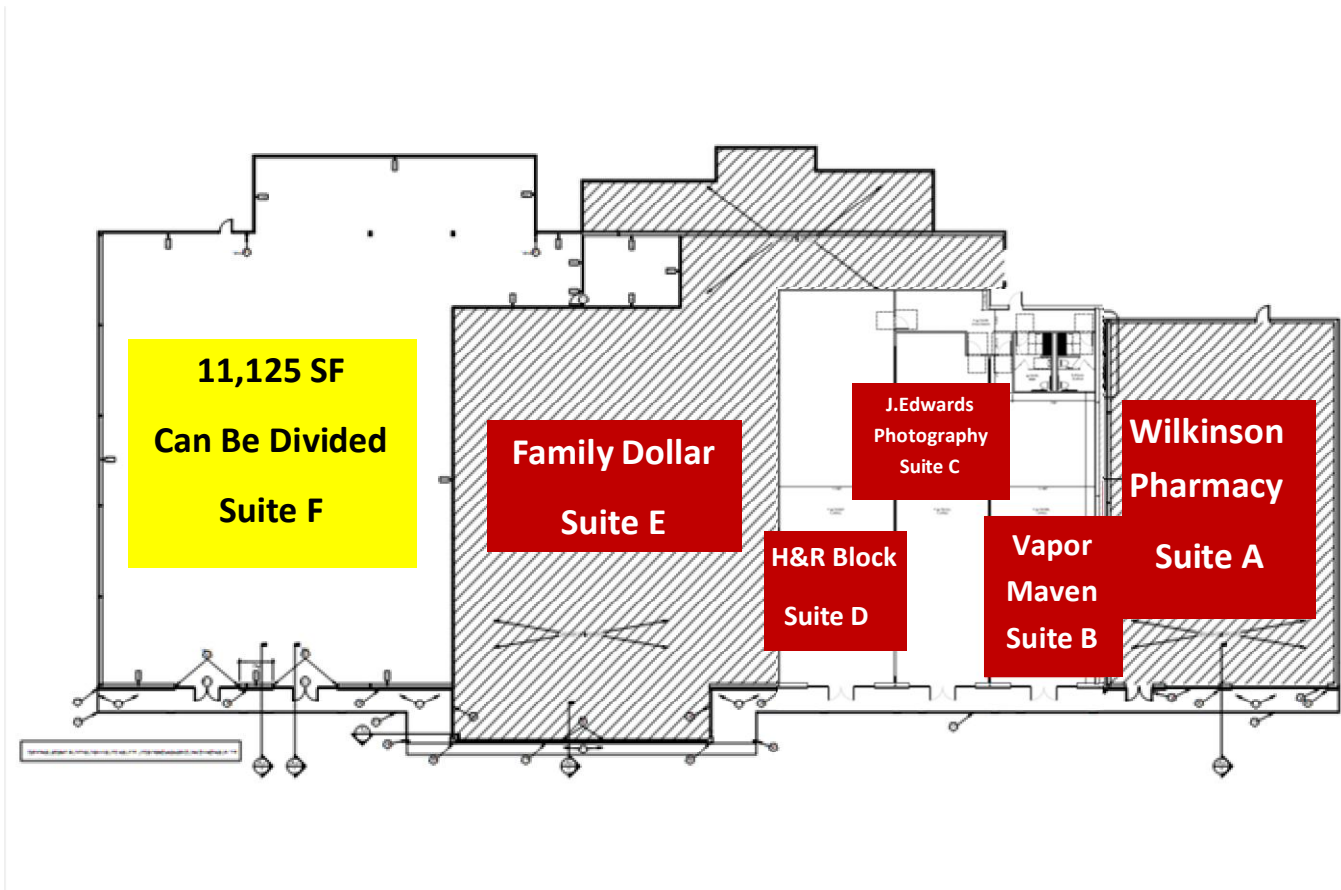

FOR ADDITIONAL INFORMATION PLEASE

Bill Beall Co., Inc.

2921 S. National Ave., Springfield, MO 65804

(417) 887-5535 email: beall@billbeall.com

605 W. 12th Street

Lamar, MO 64759



FOR ADDITIONAL INFORMATION PLEASE

Bill Beall Co., Inc.

2921 S. National Ave., Springfield, MO 65804

(417) 887-5535 email: beall@billbeall.com